

# SPH Series

Plastic Filter Housings



- Economical alternative to metal filter housings in low pressure and cold water applications
- Rugged design provides trouble-free service
- Ideal for corrosive or sensitive fluids
- Holds 10 and 20 inch length cartridges with DOE or internal o-ring end cap configurations
- Holds standard 2 1/2" and large 4 1/2" diameter cartridges.
- High temperature housings made of reinforced Nylon for use up to 200°F (93°C)
- Meets FDA requirements for potable water and food and beverage applications.
- Optional mounting bracket available for easy installation

## Applications

Water	Chemicals
Food & Beverage	Electronics
DI Water	Inks / Paints / Coatings
Coolants	Pulp & Paper

## Specifications & Operating Parameters

### Maximum Operating Pressure

125 psig (8.75 bar) @ 125°F (93°C)

### Minimum / Maximum Temperature

40°F (°C) / 125°F (93°C)

### Connections

Inlet /Outlet:

Standard: 1/2" or 3/4" FNPT

Heavy Duty (BB): 1" or 1 1/2" FNPT

### Materials of Construction

Head: FDA grade Polypropylene

Clear Sump: Styrene-Acrylonitrile

Opaque Sump: Polypropylene

### Gaskets

Standard EPR

Optional Viton

### Options

Mounting Bracket Kits

(See ordering guide for details)

## Dimensions

MODEL	A	B	C	D	E	F
SPH_5	4.28" (10.9 cm)	1.57" (4.0 cm)	1.18" (3.0 cm)	0.16" (.40 cm)	7.5" (19.0 cm)	5.7" (14.5 cm)
SPH_10	4.72" (12.0 cm)	1.57" (4.0 cm)	1.18" (3.0 cm)	0.16" (.40 cm)	10.5" (26.7 cm)	11.8" (30.0 cm)
SPH_20	4.72" (12.0 cm)	1.57" (4.0 cm)	1.18" (3.0 cm)	0.16" (.40 cm)	20.47" (52.0 cm)	22.8" (57.9 cm)
SPH_10C	5.35" (13.6 cm)	2.22" (5.6 cm)	2.28" (5.8 cm)	0.23" (0.58 cm)	10.4" (26.5 cm)	12.5" (31.8 cm)
SPH_20C	5.35" (13.6 cm)	2.22" (5.6 cm)	2.28" (5.8 cm)	0.23" (0.58 cm)	20.47" (52.0 cm)	22.8" (57.9 cm)
SPH_10BB	7.28" (18.5 cm)	3.03" (7.7 cm)	3.03" (7.7 cm)	0.275" (0.70 cm)	11.33" (28.8 cm)	14.0" (35.6 cm)
SPH_20BB	7.28" (18.5 cm)	3.03" (7.7 cm)	3.03" (7.7 cm)	0.275" (0.70 cm)	21.25" (54.0 cm)	24.0" (61.0 cm)
SPH_10HT	5.35" (13.6 cm)	2.22" (5.6 cm)	2.28" (5.8 cm)	0.23" (0.58 cm)	10.4" (26.5 cm)	12.5" (31.8 cm)
SPH_20HT	5.35" (13.6 cm)	2.22" (5.6 cm)	2.28" (5.8 cm)	0.23" (0.58 cm)	20.47" (52.0 cm)	22.8" (57.9 cm)

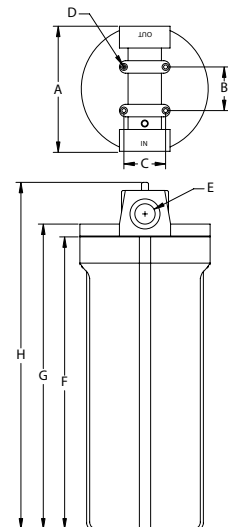

## Models

MODEL	COLORS (HEAD/SUMP) FEATURES	CARTRIDGE LENGTH	CONNECTION	GASKET	OPTIONAL MOUNTING KIT
Standard Residential SPHWW-5-12 SPHWC-5-12 SPHKB-10-34 SPHKB-20-34	WW = White/White WC = White/Clear KB = Black/Blue	5 = 4 7/8" 10 = 9 7/8" 20 = 20"	12 = 1/2" 34 = 3/4"	- E = EPR (Standard) V = Viton	- BK1
Commercial SPHKB-10-34C SPHKB-20-34C SPHKC-10-34C SPHKC-20-34C-PR	KB = Black/Blue KC = Black/Clear PR = Pressure Release Valve	10 = 9 7/8" 20 = 20"	12 = 1/2" 34 = 3/4"	E = EPR (Standard) V = Viton	BK2
Big Blue SPHKB-10-1BB SPHKB-20-1BB SPHKC-10-15BB SPHKC-20-15BB	KB = Black/Blue KC = Black/Clear	10 = 9 7/8" 20 = 20"	1 = 1" 15 = 1 1/2"	E = EPR (Standard) V = Viton	BK3
Valve-in-Head SPHWW-10-34VH SPHWC-10-34VH	WW = White/White WC = White/Clear	10*	1 = 1" 15 = 1 1/2"	E = EPR (Standard) V = Viton	Not Available
High Temperature SPHRR-10-34HT SPHRR-10-34HT	RR = Red/Red	10*	34 = 3/4"	E = EPR (Standard) V = Viton	BK2

## Filter Housings

Shelco manufactures a full line of filter housings. From our rugged single cartridge housings to our heavy duty multi-cartridge housings and bag filter housings, Shelco is the perfect choice for your filtration solutions.



### Shelco Filters

100 Bradley Street  
Middletown, CT 06457 USA

Tel: 800-543-5843 / Fax: 860-854-6120 / E-mail: [info@shelco.com](mailto:info@shelco.com)

MicroSentry™, MicroVantage™, Shelco Filters® and the Shelco logo are registered trademarks of the Tinny Corporation. Shelco Filters is a division of the Tinny Corporation.